

# CHILLFAST

## HIGH SPEED FREEZER DOOR



High Performance, High Speed  
Impactable Freezer Door System  
for Food Processing and Distribution



*Tough 'n' Ready  
For Your Challenging  
Environments*

# CHILLFAST FREEZER DOOR SYSTEM

**Applications:** Food and beverage processing, cold storage and distribution.

**The CHILLFAST insulated high speed roll-up door system can sustain temperature ranges suitable for cold rooms, chill rooms and freezers.**

This high speed door system minimizes temperature losses in cold spaces by reducing time door is open, providing substantial savings in energy consumption. Reduces ice build-up on components and walk-through areas. Optional heated air curtain provides further safety, efficiency and energy savings.

Mechanical Feature	Description	Benefit
1 <b>Insulated vinyl curtain</b> - nom. 1/2" thick - up to 13'W x 18'H	Composite - 22 oz reinforced vinyl exterior layers, dual reflective foil layers, sealed air bubble core insulation	Durable vinyl fabric exterior resistant to extreme temperatures -22°F (-30°C)
2 <b>Soft Bottom Bar</b> - heated	Flexible urethane extrusion with 2-wire electric safety reversing edge, yellow vinyl loop	Withstands accidental impact, assists seal on uneven floor
3 <b>Anodized Aluminum Guides</b> - heated	Modular extruded profiles with grey anodized finish. UHMW-PE wear strips. Vinyl fabric front/back loop seals (optional brush seals)	Easy standard assembly and mounting of accessories. Corrosion resistant. Minimizes air infiltration.
4 <b>Reset Guides</b>	Lead-in guides and slots provide semi-automatic resetting of door	Facilitates fast and reliable door resetting after an impact
5 <b>Roll Cover &amp; Operator Hood</b>	White powder coated Aluminum hoods with integrated heating - Optional stainless steel or galvanized steel	Protects curtain roll and drive system from ice build-up, ensures reliable operation
6 <b>Emergency Egress</b>	Standard hand crank	Allows safe exit through door in case of power failure

NOTE: Curtain not rated for windload. Optional windribs available.

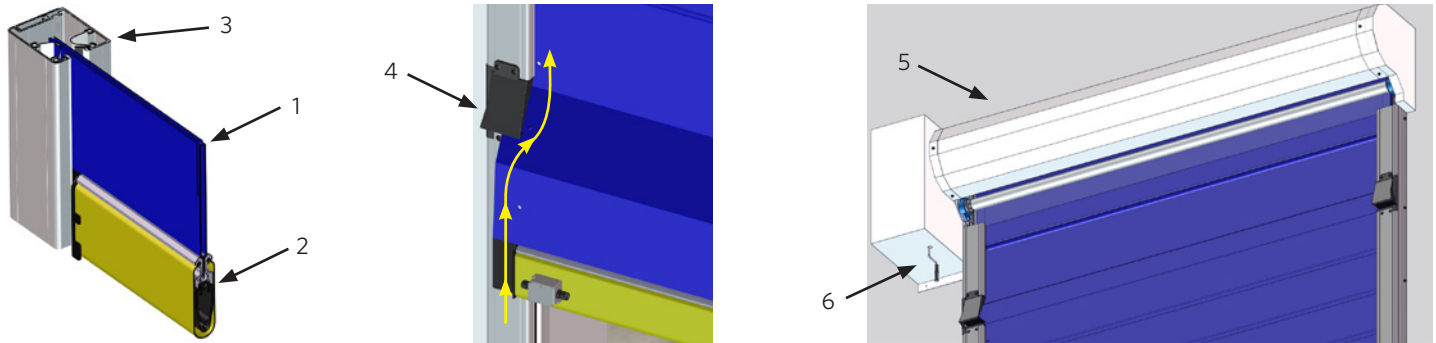

Electrical Feature	Description	Benefit
7 <b>Variable Frequency Drive System (VFD)</b>	High speed, reliable 0.85 HP operator with on-board frequency drive. Springless direct drive.	Soft start, soft stop, high speed, long life, energy efficient, up to 108 ips opening speed
8 <b>NEMA 4X Control Panel</b> 16" x 20"	Fibreglass enclosure, emergency stop, door control buttons, Plug and Play connections	Moisture proof, impact & corrosion resistant, easy control access, easy to install, no maintenance
9 <b>Plug and Play cable system</b>	Standard cabling & connectors at control panel and operator	Less wiring needed, reduced installation and maintenance labour
<b>Heater Cable System</b> with GFCI protection	Electric heater cables in hoods, guides & bottom bar, GFCI protection built into panel	Prevents ice build-up, ensures safe and reliable operation. GFCI reduces electric shock and fire hazards.
<b>Air Curtain system</b> (Optional)	Heated or non-heated air blower with plenum and mounting hardware	Improves energy efficiency of doorway, prevents ice build-up

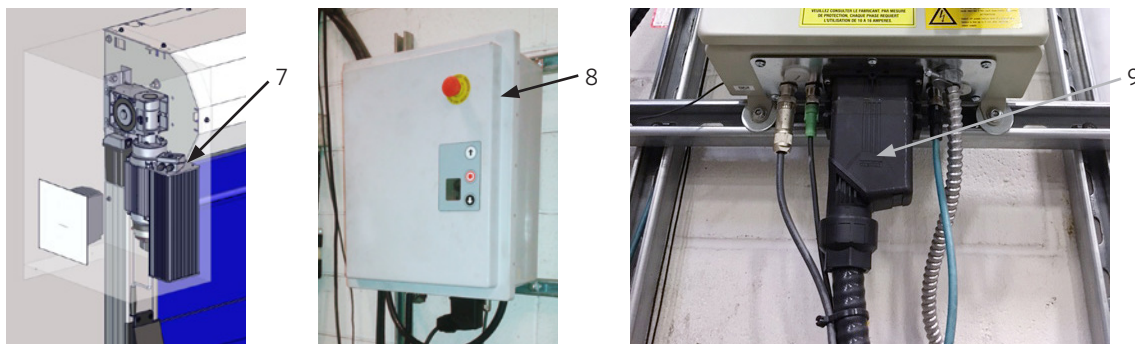

**Warranty:**

Five years or 1,000,000 cycles on operator with frequency drive.

Two years on all other parts and workmanship. One year on vinyl curtain.

Toll-free 1-866-792-9968 Fax 1-705-735-9564 info@tnrdoors.com TNRdoors.com

